

Low-voltage instrument current transformer

CLA 1.2

Screw
Transformer width

M10
85 mm

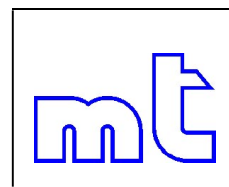

insulation voltage 0,72 kV, test voltage 3 kV, frequency 50 - 60 Hz,
 $I_{therm} = 60 \times I_{1n}$, $I_{dyn} = 150 \times I_{1n}$

Primary current range 10 – 250 A



A completely enclosed mini current transformer, most appropriate for use in low-voltage switchboard plants for indoor installation. It can be used for the connection of ammeters and current circuits of meters, protective and other measuring devices.

Core and secondary winding are housed in a black case of self-extinguishing material. Insulation class E, max. constant temperature 120°C.

The secondary terminals are sealable.

The transformer can be mounted in all position on busbars of square or round cross-section. It can also be mounted on the specially made frames by means of four screws in such a way that the primary conductor freely passes through the transformer hole.

The transformers are made according to the standards ČSN 35 1360, ČSN 35 1301, ČSN EN 60044-1, ČSN EN 61869-2 (Czech Standards) and of course IEC 60044-1 and IEC 61869-2. Each transformer is thoroughly tested in the factory. The factory test certificate is provided upon request.

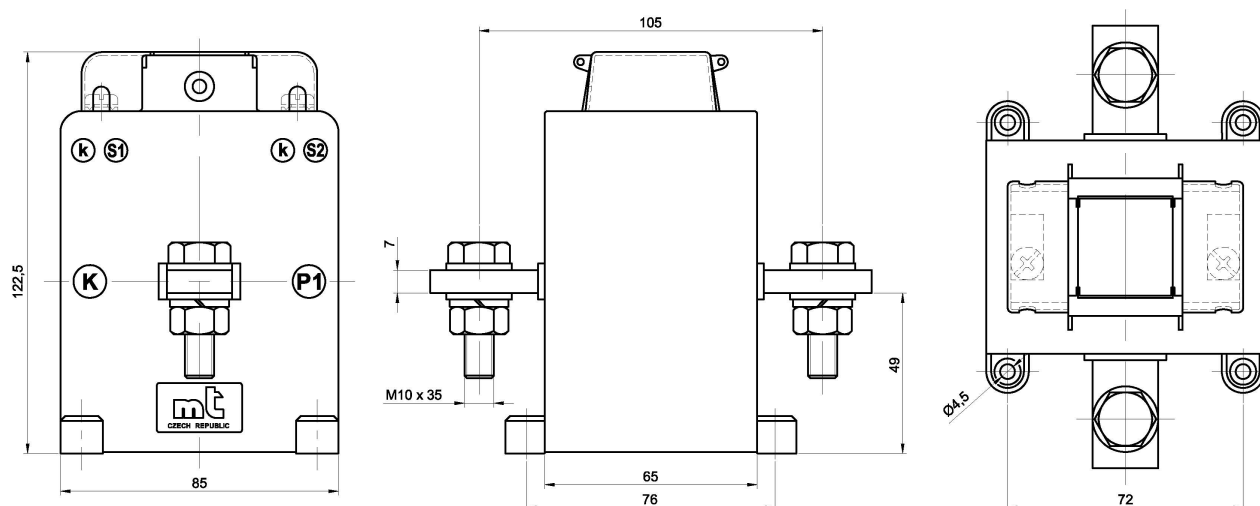

Low-voltage instrument current transformer

CLA 1.3

Screw
Transformer width

M10
85 mm

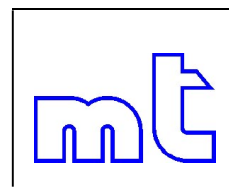

insulation voltage 0,72 kV, test voltage 3 kV, frequency 50 - 60 Hz,
 $I_{therm} = 60 \times I_{1n}$, $I_{dyn} = 150 \times I_{1n}$

Primary current range 10 – 250 A



A completely enclosed mini current transformer, most appropriate for use in low-voltage switchboard plants for indoor installation. It can be used for the connection of ammeters and current circuits of meters, protective and other measuring devices.

Core and secondary winding are housed in a black case of self-extinguishing material. Insulation class E, max. constant temperature 120°C.

The secondary terminals are sealable.

The transformer can be mounted in all position on busbars of square or round cross-section. It can also be mounted on the specially made frames by means of four screws in such a way that the primary conductor freely passes through the transformer hole.

The transformers are made according to the standards ČSN 35 1360, ČSN 35 1301, ČSN EN 60044-1, ČSN EN 61869-2 (Czech Standards) and of course IEC 60044-1 and IEC 61869-2. Each transformer is thoroughly tested in the factory. The factory test certificate is provided upon request.

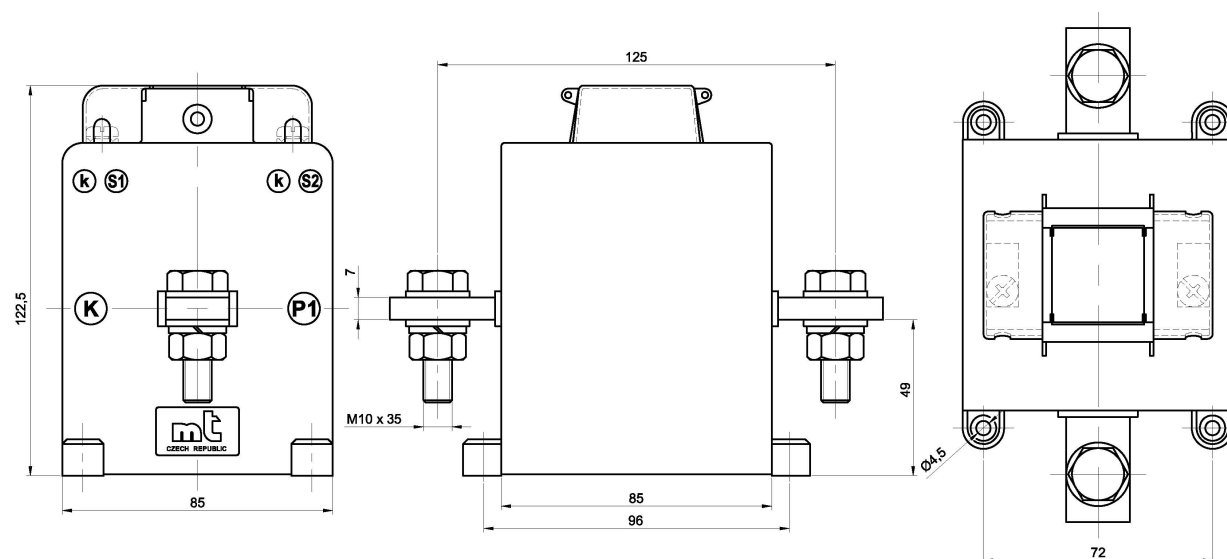

Low-voltage instrument current transformer

CLA 2.1

insulation voltage 0,72 kV, test voltage 3 kV, frequency 50 - 60 Hz,
 $I_{therm} = 60 \times I_{1n}$, $I_{dyn} = 150 \times I_{1n}$

Primary current range 50 – 800 A

Primary bar

Round conductor
Transformer width

40x10 mm
20x30 mm
 ϕ 27 mm
85 mm

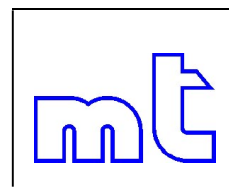

A completely enclosed mini current transformer, most appropriate for use in low-voltage switchboard plants for indoor installation. It can be used for the connection of ammeters and current circuits of meters, protective and other measuring devices.

Core and secondary winding are housed in a black case of self-extinguishing material. Insulation class E, max. constant temperature 120°C.

The secondary terminals are sealable.

The transformer can be mounted in all position on busbars of square or round cross-section. It can also be mounted on the specially made frames by means of four screws in such a way that the primary conductor freely passes through the transformer hole.

The transformers are made according to the standards ČSN 35 1360, ČSN 35 1301, ČSN EN 60044-1, ČSN EN 61869-2 (Czech Standards) and of course IEC 60044-1 and IEC 61869-2. Each transformer is thoroughly tested in the factory. The factory test certificate is provided upon request.

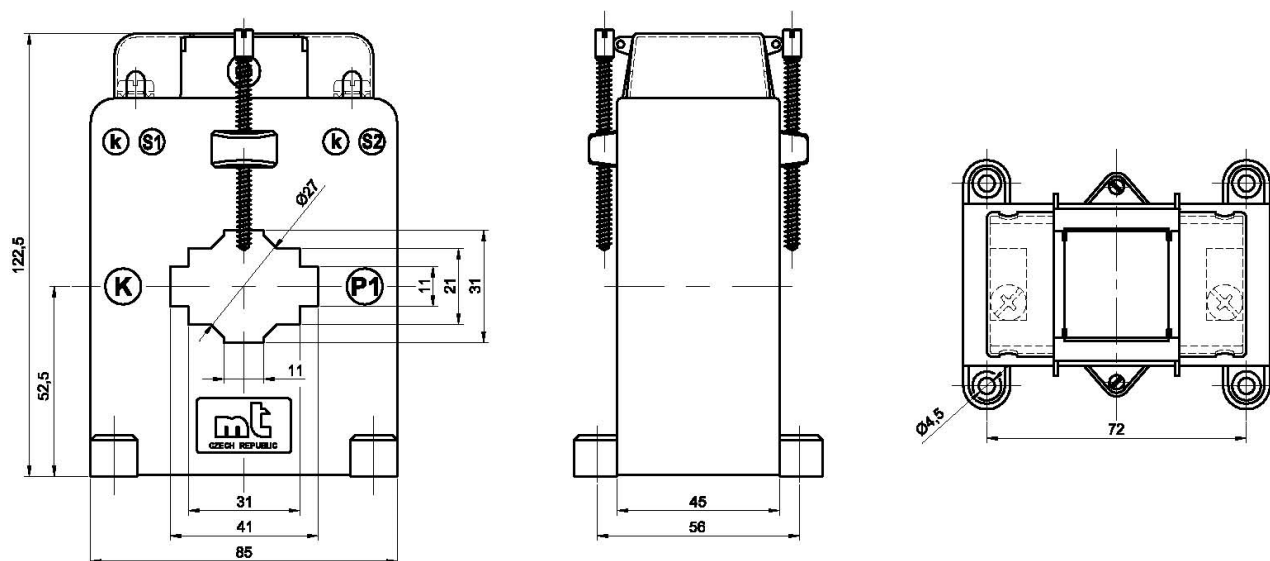

Low-voltage instrument current transformer

CLA 2.2

Primary bar

Round conductor
Transformer width

40x10 mm
20x30 mm
 ϕ 27 mm
85 mm

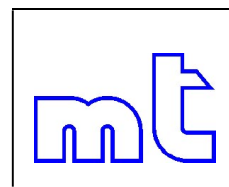

insulation voltage 0,72 kV, test voltage 3 kV, frequency 50 - 60 Hz,
 $I_{therm} = 60 \times I_{1n}$, $I_{dyn} = 150 \times I_{1n}$

Primary current range 50 – 800 A

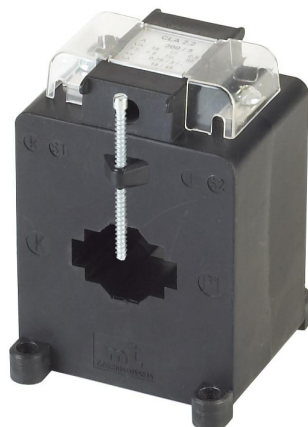

A completely enclosed mini current transformer, most appropriate for use in low-voltage switchboard plants for indoor installation. It can be used for the connection of ammeters and current circuits of meters, protective and other measuring devices.

Core and secondary winding are housed in a black case of self-extinguishing material. Insulation class E, max. constant temperature 120°C.

The secondary terminals are sealable.

The transformer can be mounted in all position on busbars of square or round cross-section. It can also be mounted on the specially made frames by means of four screws in such a way that the primary conductor freely passes through the transformer hole.

The transformers are made according to the standards ČSN 35 1360, ČSN 35 1301, ČSN EN 60044-1, ČSN EN 61869-2 (Czech Standards) and of course IEC 60044-1 and IEC 61869-2. Each transformer is thoroughly tested in the factory. The factory test certificate is provided upon request.

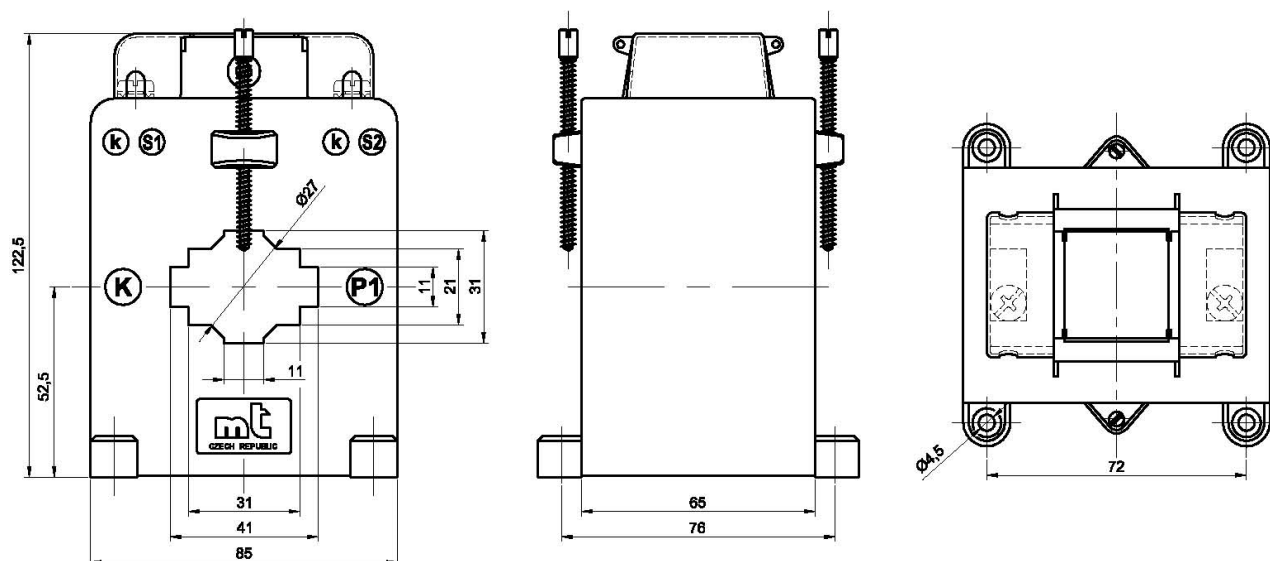

Low-voltage instrument current transformer

CLA 2.3

Primary bar

Round conductor
Transformer width

40x10 mm
20x30 mm
 ϕ 27 mm
85 mm

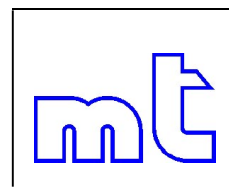

insulation voltage 0,72 kV, test voltage 3 kV, frequency 50 - 60 Hz,
 $I_{therm} = 60 \times I_{1n}$, $I_{dyn} = 150 \times I_{1n}$

Primary current range 50 – 800 A

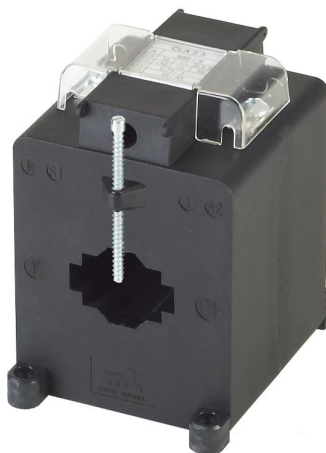

A completely enclosed mini current transformer, most appropriate for use in low-voltage switchboard plants for indoor installation. It can be used for the connection of ammeters and current circuits of meters, protective and other measuring devices.

Core and secondary winding are housed in a black case of self-extinguishing material. Insulation class E, max. constant temperature 120°C.

The secondary terminals are sealable.

The transformer can be mounted in all position on busbars of square or round cross-section. It can also be mounted on the specially made frames by means of four screws in such a way that the primary conductor freely passes through the transformer hole.

The transformers are made according to the standards ČSN 35 1360, ČSN 35 1301, ČSN EN 60044-1, ČSN EN 61869-2 (Czech Standards) and of course IEC 60044-1 and IEC 61869-2. Each transformer is thoroughly tested in the factory. The factory test certificate is provided upon request.

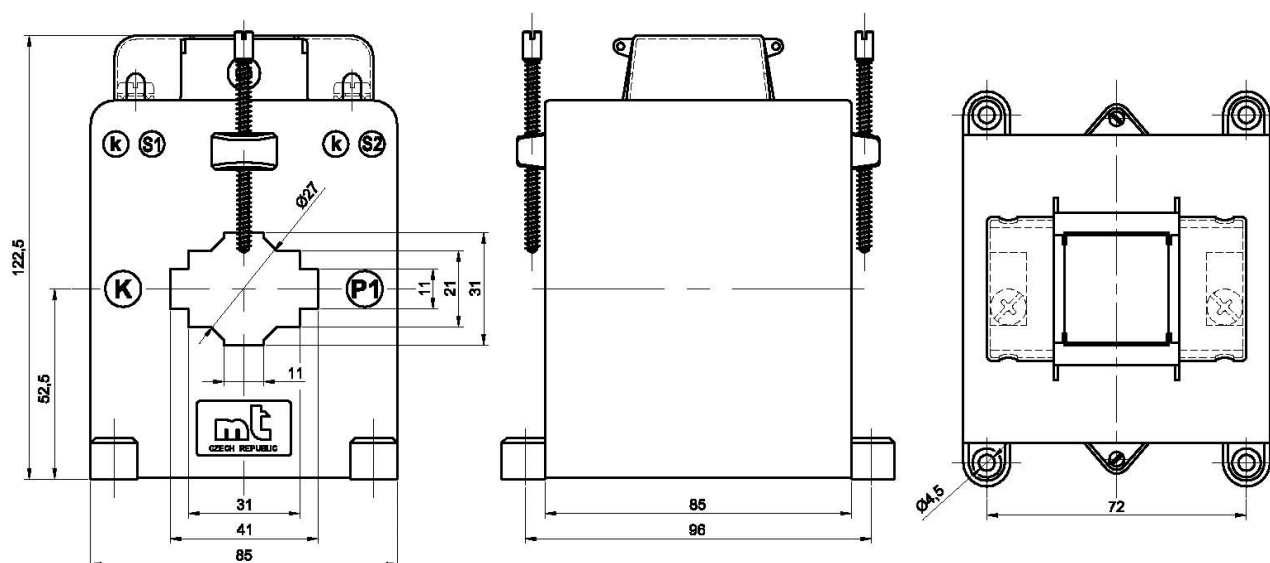

Low-voltage instrument current transformer

CLA 3.1

Primary bar

Round conductor
Transformer width

80x10 mm
60x30 mm
 ϕ 51 mm
130 mm

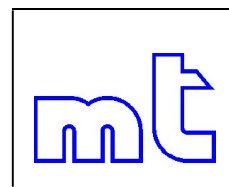

insulation voltage 0,72 kV, test voltage 3 kV, frequency 50 - 60 Hz,
 $I_{therm} = 60 \times I_{1n}$, $I_{dyn} = 150 \times I_{1n}$

Primary current range 200 – 2000 A



A completely enclosed mini current transformer, most appropriate for use in low-voltage switchboard plants for indoor installation. It can be used for the connection of ammeters and current circuits of meters, protective and other measuring devices.

Core and secondary winding are housed in a black case of self-extinguishing material. Insulation class E, max. constant temperature 120°C.

The secondary terminals are sealable.

The transformer can be mounted in all position on busbars of square or round cross-section. It can also be mounted on the specially made frames by means of four screws in such a way that the primary conductor freely passes through the transformer hole.

The transformers are made according to the standards ČSN 35 1360, ČSN 35 1301, ČSN EN 60044-1, ČSN EN 61869-2 (Czech Standards) and of course IEC 60044-1 and IEC 61869-2. Each transformer is thoroughly tested in the factory. The factory test certificate is provided upon request.

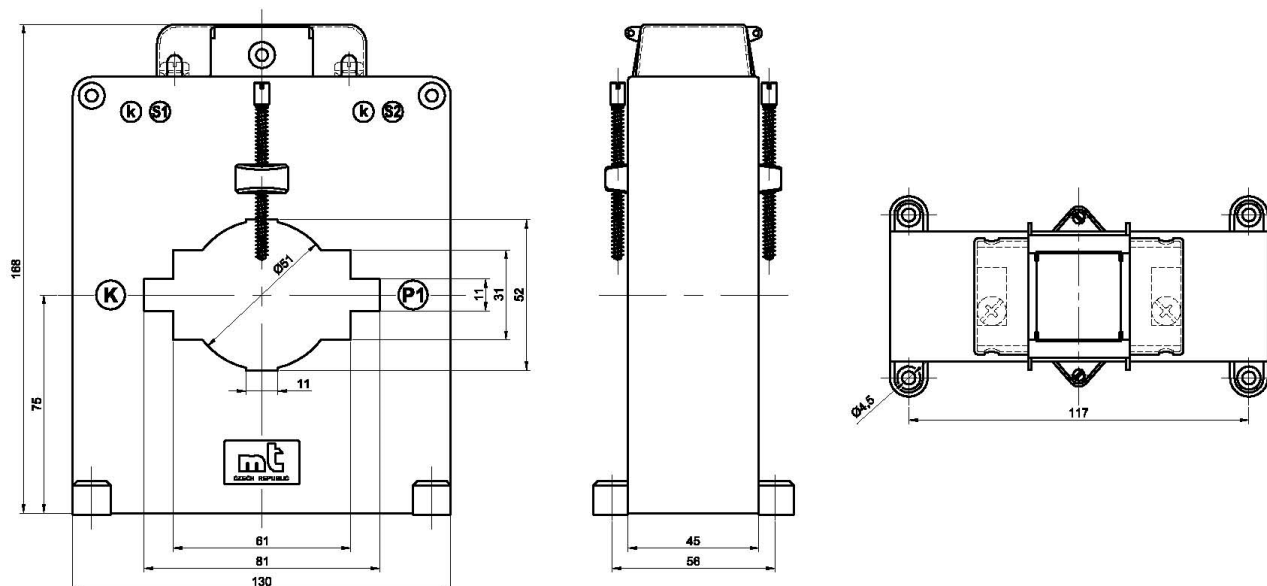

Low-voltage instrument current transformer

CLA 3.2

Primary bar

Round conductor

Transformer width

80x10 mm

60x30 mm

φ 51 mm

130 mm

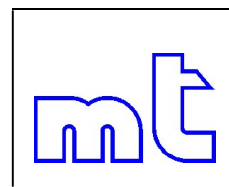

insulation voltage 0,72 kV, test voltage 3 kV, frequency 50 - 60 Hz,
 $I_{therm} = 60 \times I_{1n}$, $I_{dyn} = 150 \times I_{1n}$

Primary current range 200 – 2000 A



A completely enclosed mini current transformer, most appropriate for use in low-voltage switchboard plants for indoor installation. It can be used for the connection of ammeters and current circuits of meters, protective and other measuring devices.

Core and secondary winding are housed in a black case of self-extinguishing material. Insulation class E, max. constant temperature 120°C.

The secondary terminals are sealable.

The transformer can be mounted in all position on busbars of square or round cross-section. It can also be mounted on the specially made frames by means of four screws in such a way that the primary conductor freely passes through the transformer hole.

The transformers are made according to the standards ČSN 35 1360, ČSN 35 1301, ČSN EN 60044-1, ČSN EN 61869-2 (Czech Standards) and of course IEC 60044-1 and IEC 61869-2. Each transformer is thoroughly tested in the factory. The factory test certificate is provided upon request.

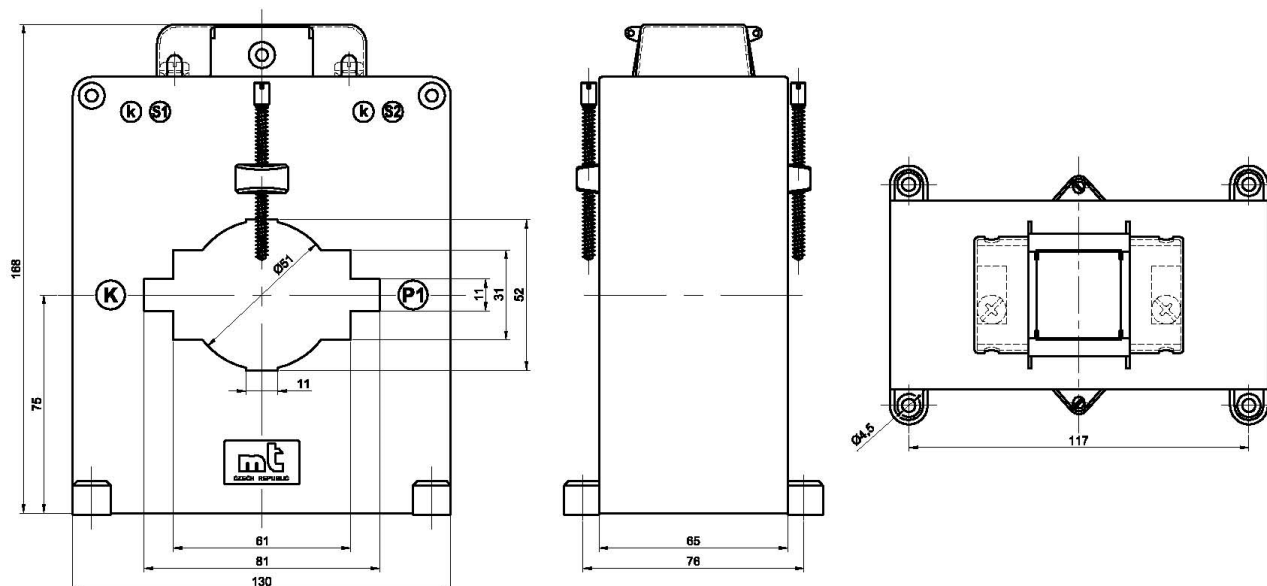

Low-voltage instrument current transformer

CLA 1.2S

Screw
Transformer width

M 8
85 mm

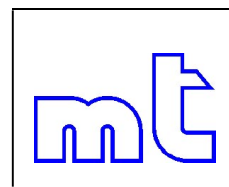

insulation voltage 0,72 kV, test voltage 3 kV, frequency 50 - 60 Hz,
 $I_{therm} = 60 \times I_{1n}$, $I_{dyn} = 150 \times I_{1n}$

Primary current range 1 – 15 A



A completely enclosed mini current transformer, most appropriate for use in low-voltage switchboard plants for indoor installation. It can be used for the connection of ammeters and current circuits of meters, protective and other measuring devices.

Core and secondary winding are housed in a black case of self-extinguishing material. Insulation class E, max. constant temperature 120°C.

The secondary terminals are sealable.

The transformer can be mounted in all position on busbars of square or round cross-section. It can also be mounted on the specially made frames by means of four screws in such a way that the primary conductor freely passes through the transformer hole.

The transformers are made according to the standards ČSN 35 1360, ČSN 35 1301, ČSN EN 60044-1, ČSN EN 61869-2 (Czech Standards) and of course IEC 60044-1 and IEC 61869-2. Each transformer is thoroughly tested in the factory. The factory test certificate is provided upon request.

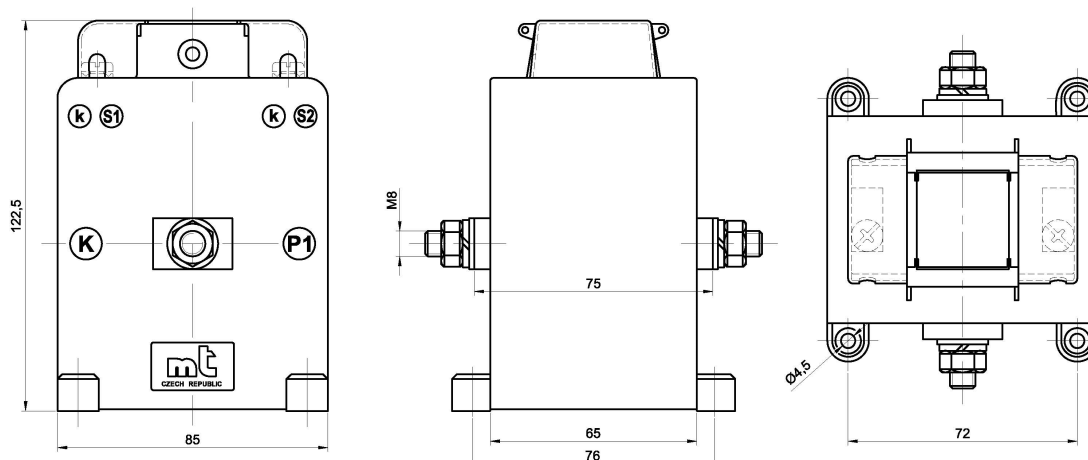

Low-voltage instrument current transformer

CLA 1.3S

Screw
Transformer width

M 8
85 mm

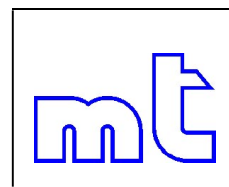

insulation voltage 0,72 kV, test voltage 3 kV, frequency 50 - 60 Hz,
 $I_{therm} = 60 \times I_{1n}$, $I_{dyn} = 150 \times I_{1n}$

Primary current range 1 – 15 A

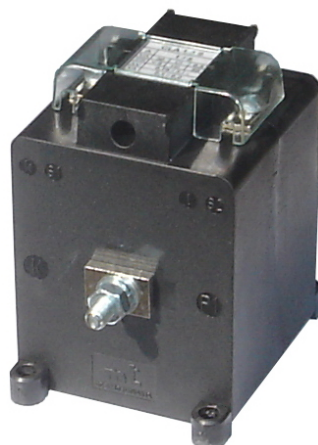

A completely enclosed mini current transformer, most appropriate for use in low-voltage switchboard plants for indoor installation. It can be used for the connection of ammeters and current circuits of meters, protective and other measuring devices.

Core and secondary winding are housed in a black case of self-extinguishing material. Insulation class E, max. constant temperature 120°C.

The secondary terminals are sealable.

The transformer can be mounted in all position on busbars of square or round cross-section. It can also be mounted on the specially made frames by means of four screws in such a way that the primary conductor freely passes through the transformer hole.

The transformers are made according to the standards ČSN 35 1360, ČSN 35 1301, ČSN EN 60044-1, ČSN EN 61869-2 (Czech Standards) and of course IEC 60044-1 and IEC 61869-2. Each transformer is thoroughly tested in the factory. The factory test certificate is provided upon request.

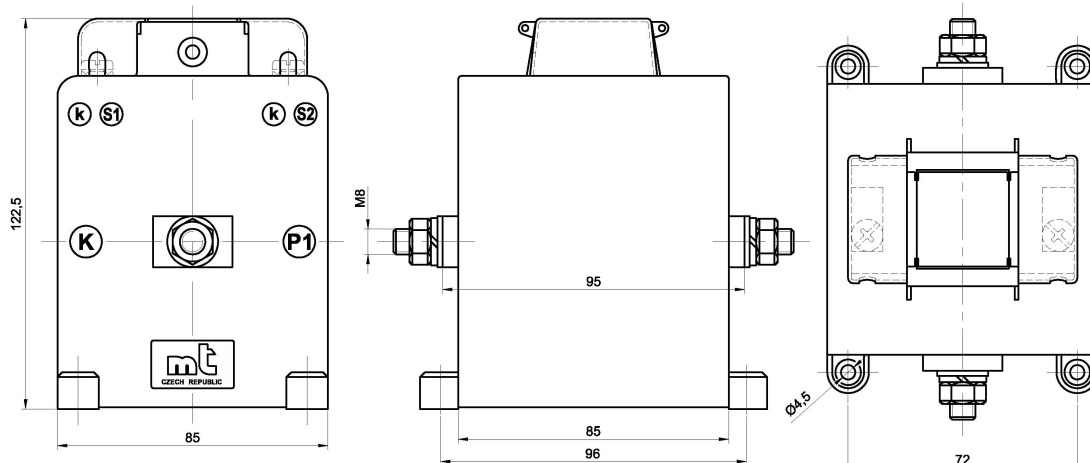

Low-voltage instrument current transformer

CLB 0.91

Terminal
Transformer width

M6
90 mm

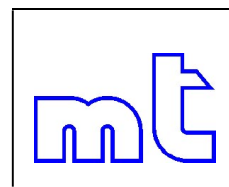

insulation voltage 0,72 kV, test voltage 3 kV, frequency 50 - 60 Hz,
 $I_{therm} = 60 \times I_{1n}$, $I_{dyn} = 150 \times I_{1n}$

Primary current range 1 – 15 A



A completely enclosed mini current transformer, most appropriate for use in low-voltage switchboard plants for indoor installation. It can be used for the connection of ammeters and current circuits of meters, protective and other measuring devices.

Core and secondary winding are housed in a black case of self-extinguishing material. Insulation class E, max. constant temperature 120°C.

The secondary terminals are sealable.

The transformer can be mounted in all position on busbars of square or round cross-section. It can also be mounted on the specially made frames by means of four screws in such a way that the primary conductor freely passes through the transformer hole.

The transformers are made according to the standards ČSN 35 1360, ČSN 35 1301, ČSN EN 60044-1, ČSN EN 61869-2 (Czech Standards) and of course IEC 60044-1 and IEC 61869-2. Each transformer is thoroughly tested in the factory. The factory test certificate is provided upon request.

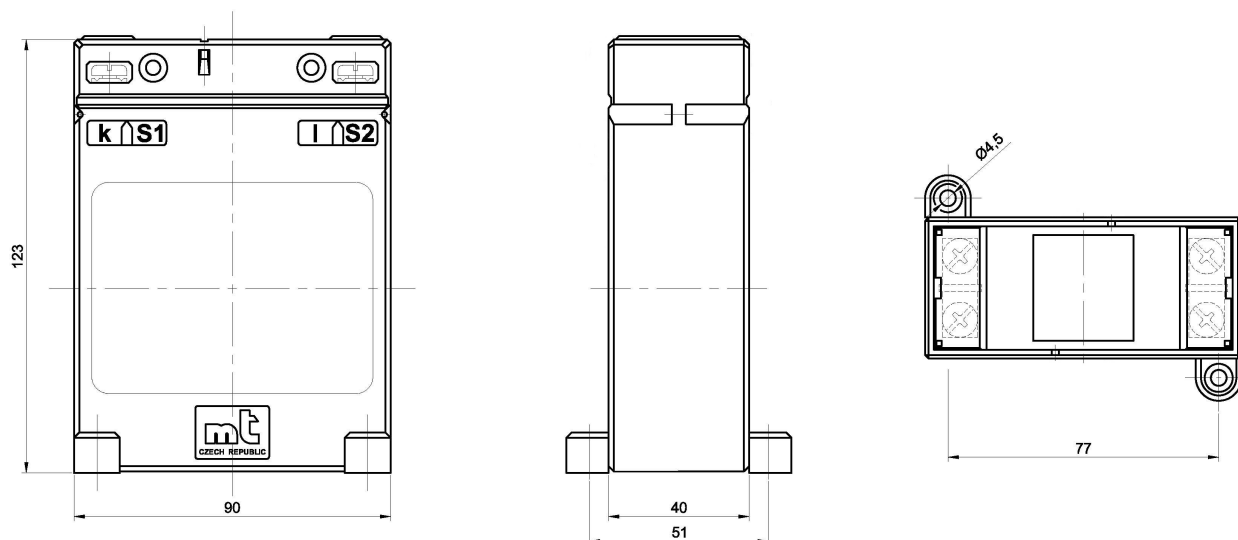

Low-voltage instrument current transformer

CLB 0.92

Terminal
Transformer width

M6
90 mm

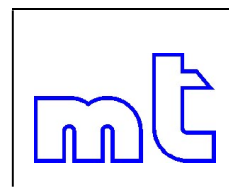

insulation voltage 0,72 kV, test voltage 3 kV, frequency 50 - 60 Hz,
 $I_{therm} = 60 \times I_{1n}$, $I_{dyn} = 150 \times I_{1n}$

Primary current range 1 – 15 A



A completely enclosed mini current transformer, most appropriate for use in low-voltage switchboard plants for indoor installation. It can be used for the connection of ammeters and current circuits of meters, protective and other measuring devices.

Core and secondary winding are housed in a black case of self-extinguishing material. Insulation class E, max. constant temperature 120°C.

The secondary terminals are sealable.

The transformer can be mounted in all position on busbars of square or round cross-section. It can also be mounted on the specially made frames by means of four screws in such a way that the primary conductor freely passes through the transformer hole.

The transformers are made according to the standards ČSN 35 1360, ČSN 35 1301, ČSN EN 60044-1, ČSN EN 61869-2 (Czech Standards) and of course IEC 60044-1 and IEC 61869-2. Each transformer is thoroughly tested in the factory. The factory test certificate is provided upon request.

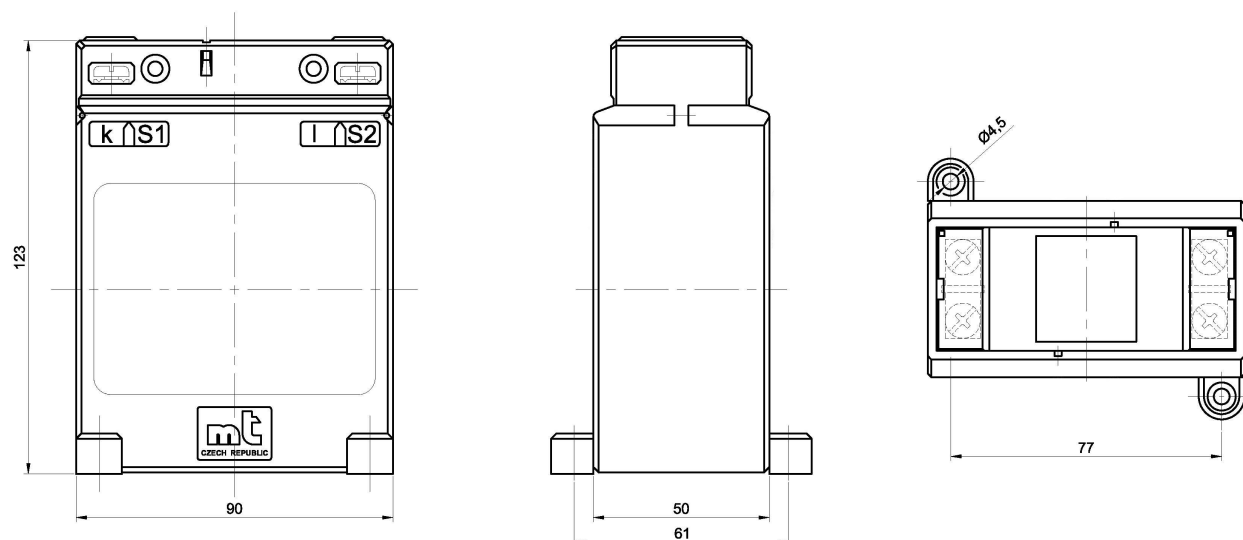

Low-voltage instrument current transformer

CLB 3.91

Primary bar

Round conductor
Transformer width

30x10 mm
20x15 mm
 ϕ 15 mm
90 mm

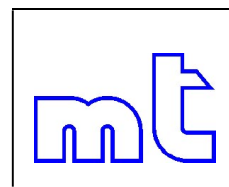

insulation voltage 0,72 kV, test voltage 3 kV, frequency 50 - 60 Hz,
 $I_{therm} = 60 \times I_{1n}$, $I_{dyn} = 150 \times I_{1n}$

Primary current range 50 – 300 A



A completely enclosed mini current transformer, most appropriate for use in low-voltage switchboard plants for indoor installation. It can be used for the connection of ammeters and current circuits of meters, protective and other measuring devices.

Core and secondary winding are housed in a black case of self-extinguishing material. Insulation class E, max. constant temperature 120°C.

The secondary terminals are sealable.

The transformer can be mounted in all position on busbars of square or round cross-section. It can also be mounted on the specially made frames by means of four screws in such a way that the primary conductor freely passes through the transformer hole.

The transformers are made according to the standards ČSN 35 1360, ČSN 35 1301, ČSN EN 60044-1, ČSN EN 61869-2 (Czech Standards) and of course IEC 60044-1 and IEC 61869-2. Each transformer is thoroughly tested in the factory. The factory test certificate is provided upon request.

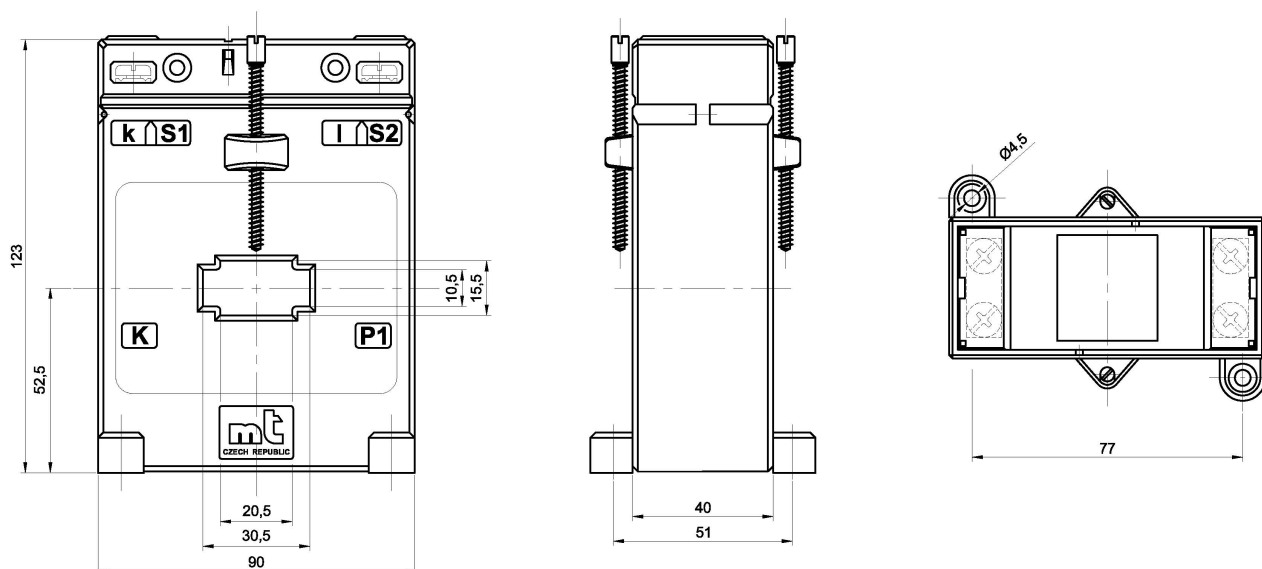

Low-voltage instrument current transformer

CLB 3.92

Primary bar

Round conductor
Transformer width

30x10 mm
20x15 mm
 ϕ 15 mm
90 mm

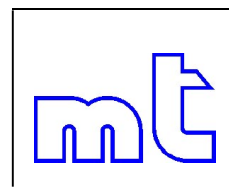

insulation voltage 0,72 kV, test voltage 3 kV, frequency 50 - 60 Hz,
 $I_{therm} = 60 \times I_{1n}$, $I_{dyn} = 150 \times I_{1n}$

Primary current range 50 – 300 A



A completely enclosed mini current transformer, most appropriate for use in low-voltage switchboard plants for indoor installation. It can be used for the connection of ammeters and current circuits of meters, protective and other measuring devices.

Core and secondary winding are housed in a black case of self-extinguishing material. Insulation class E, max. constant temperature 120°C.

The secondary terminals are sealable.

The transformer can be mounted in all position on busbars of square or round cross-section. It can also be mounted on the specially made frames by means of four screws in such a way that the primary conductor freely passes through the transformer hole.

The transformers are made according to the standards ČSN 35 1360, ČSN 35 1301, ČSN EN 60044-1, ČSN EN 61869-2 (Czech Standards) and of course IEC 60044-1 and IEC 61869-2. Each transformer is thoroughly tested in the factory. The factory test certificate is provided upon request.

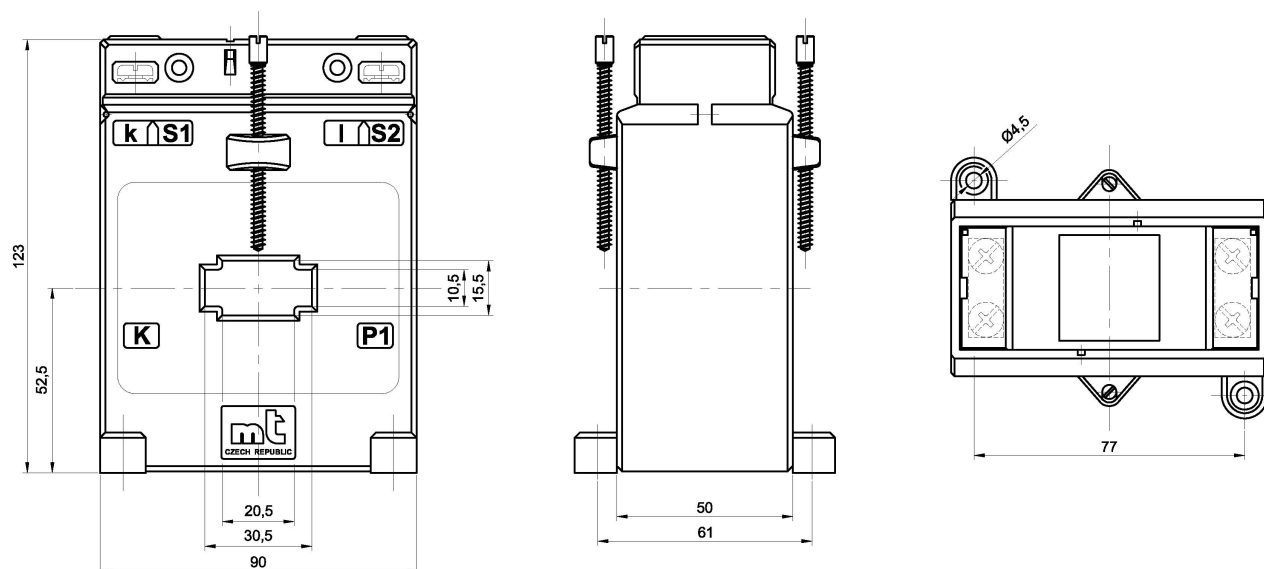

Low-voltage instrument current transformer

CLB 4.91

Primary bar

Round conductor
Transformer width

40x10 mm
30x20 mm
 ϕ 30 mm
90 mm

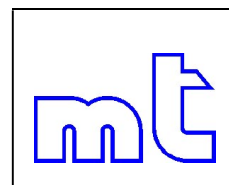

insulation voltage 0,72 kV, test voltage 3 kV, frequency 50 - 60 Hz,
 $I_{therm} = 60 \times I_{1n}$, $I_{dyn} = 150 \times I_{1n}$

Primary current range 50 – 800 A



A completely enclosed mini current transformer, most appropriate for use in low-voltage switchboard plants for indoor installation. It can be used for the connection of ammeters and current circuits of meters, protective and other measuring devices.

Core and secondary winding are housed in a black case of self-extinguishing material. Insulation class E, max. constant temperature 120°C.

The secondary terminals are sealable.

The transformer can be mounted in all position on busbars of square or round cross-section. It can also be mounted on the specially made frames by means of four screws in such a way that the primary conductor freely passes through the transformer hole.

The transformers are made according to the standards ČSN 35 1360, ČSN 35 1301, ČSN EN 60044-1, ČSN EN 61869-2 (Czech Standards) and of course IEC 60044-1 and IEC 61869-2. Each transformer is thoroughly tested in the factory. The factory test certificate is provided upon request.

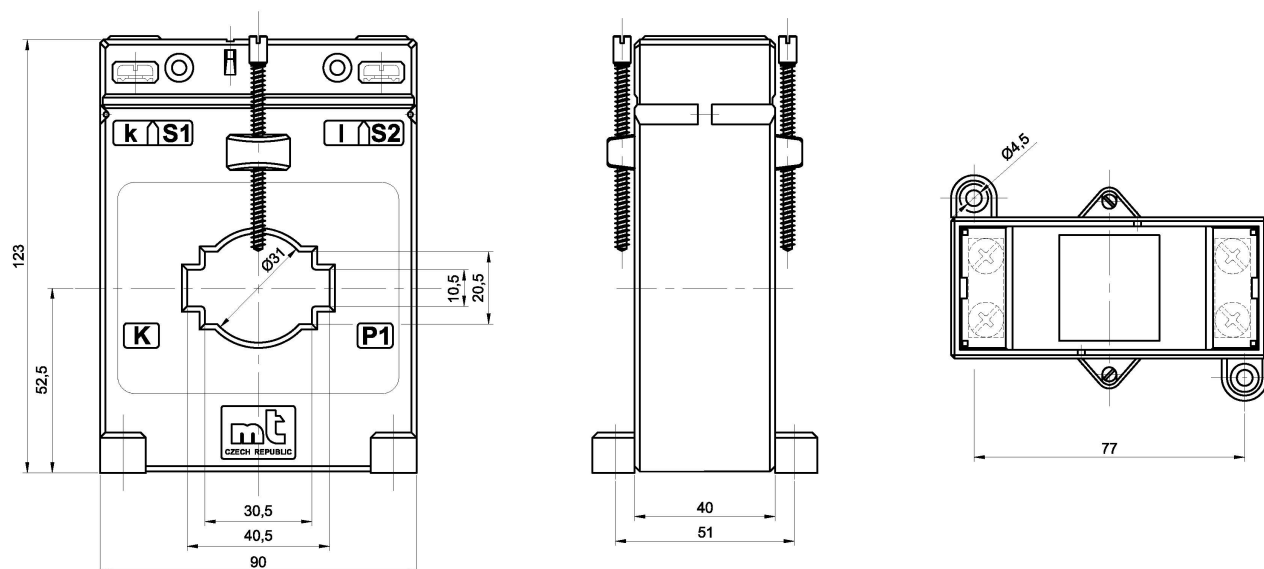

Low-voltage instrument current transformer

CLB 4.92

Primary bar

Round conductor
Transformer width

40x10 mm
30x20 mm
 ϕ 30 mm
90 mm

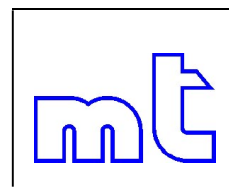

insulation voltage 0,72 kV, test voltage 3 kV, frequency 50 - 60 Hz,
 $I_{therm} = 60 \times I_{1n}$, $I_{dyn} = 150 \times I_{1n}$

Primary current range 50 – 800 A



A completely enclosed mini current transformer, most appropriate for use in low-voltage switchboard plants for indoor installation. It can be used for the connection of ammeters and current circuits of meters, protective and other measuring devices.

Core and secondary winding are housed in a black case of self-extinguishing material. Insulation class E, max. constant temperature 120°C.

The secondary terminals are sealable.

The transformer can be mounted in all position on busbars of square or round cross-section. It can also be mounted on the specially made frames by means of four screws in such a way that the primary conductor freely passes through the transformer hole.

The transformers are made according to the standards ČSN 35 1360, ČSN 35 1301, ČSN EN 60044-1, ČSN EN 61869-2 (Czech Standards) and of course IEC 60044-1 and IEC 61869-2. Each transformer is thoroughly tested in the factory. The factory test certificate is provided upon request.

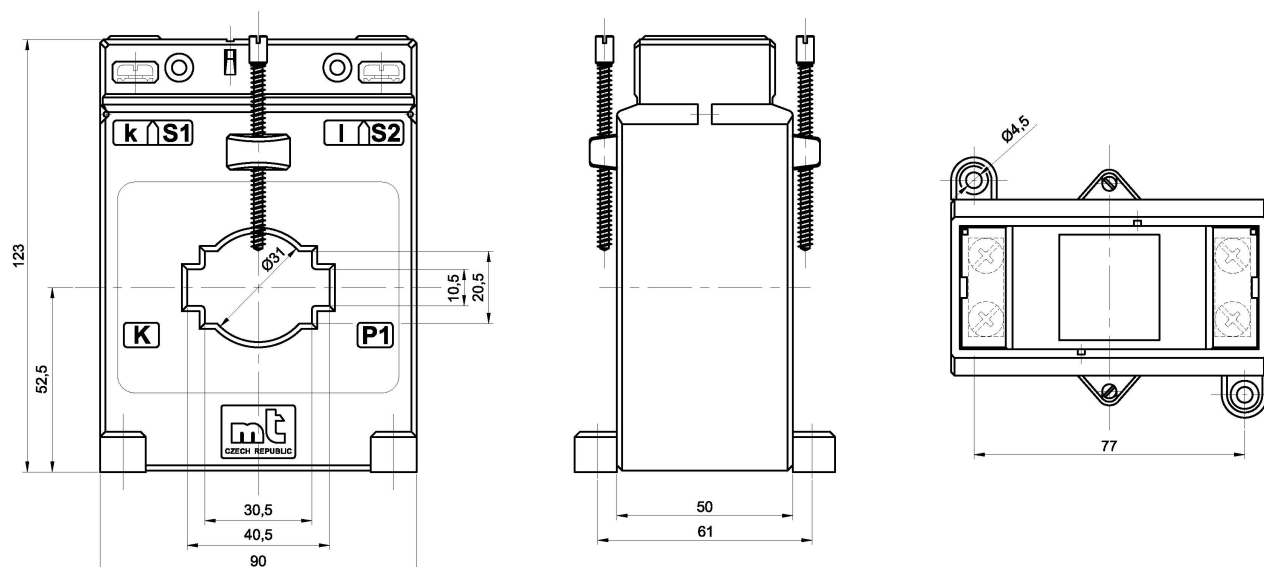

Low-voltage instrument current transformer

CLB 5.91

Primary bar

Round conductor
Transformer width

50x10 mm
40x20 mm
 ϕ 36,5 mm
90 mm

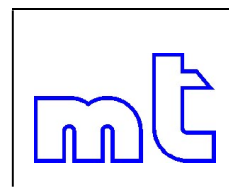

insulation voltage 0,72 kV, test voltage 3 kV, frequency 50 - 60 Hz,
 $I_{therm} = 60 \times I_{1n}$, $I_{dyn} = 150 \times I_{1n}$

Primary current range 75 – 1000 A



A completely enclosed mini current transformer, most appropriate for use in low-voltage switchboard plants for indoor installation. It can be used for the connection of ammeters and current circuits of meters, protective and other measuring devices.

Core and secondary winding are housed in a black case of self-extinguishing material. Insulation class E, max. constant temperature 120°C.

The secondary terminals are sealable.

The transformer can be mounted in all position on busbars of square or round cross-section. It can also be mounted on the specially made frames by means of four screws in such a way that the primary conductor freely passes through the transformer hole.

The transformers are made according to the standards ČSN 35 1360, ČSN 35 1301, ČSN EN 60044-1, ČSN EN 61869-2 (Czech Standards) and of course IEC 60044-1 and IEC 61869-2. Each transformer is thoroughly tested in the factory. The factory test certificate is provided upon request.

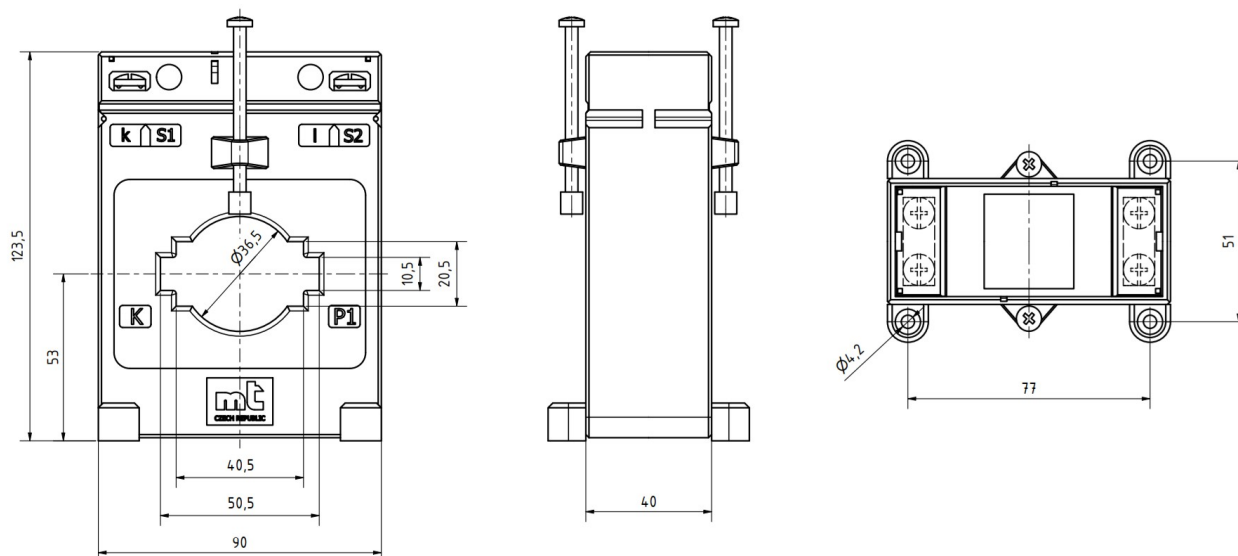

Low-voltage instrument current transformer

CLB 5.92

Primary bar

Round conductor
Transformer width

50x10 mm
40x20 mm
 ϕ 36,5 mm
90 mm

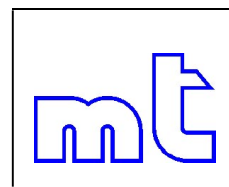

insulation voltage 0,72 kV, test voltage 3 kV, frequency 50 - 60 Hz,
 $I_{therm} = 60 \times I_{1n}$, $I_{dyn} = 150 \times I_{1n}$

Primary current range 75 – 1000 A



A completely enclosed mini current transformer, most appropriate for use in low-voltage switchboard plants for indoor installation. It can be used for the connection of ammeters and current circuits of meters, protective and other measuring devices.

Core and secondary winding are housed in a black case of self-extinguishing material. Insulation class E, max. constant temperature 120°C.

The secondary terminals are sealable.

The transformer can be mounted in all position on busbars of square or round cross-section. It can also be mounted on the specially made frames by means of four screws in such a way that the primary conductor freely passes through the transformer hole.

The transformers are made according to the standards ČSN 35 1360, ČSN 35 1301, ČSN EN 60044-1, ČSN EN 61869-2 (Czech Standards) and of course IEC 60044-1 and IEC 61869-2. Each transformer is thoroughly tested in the factory. The factory test certificate is provided upon request.

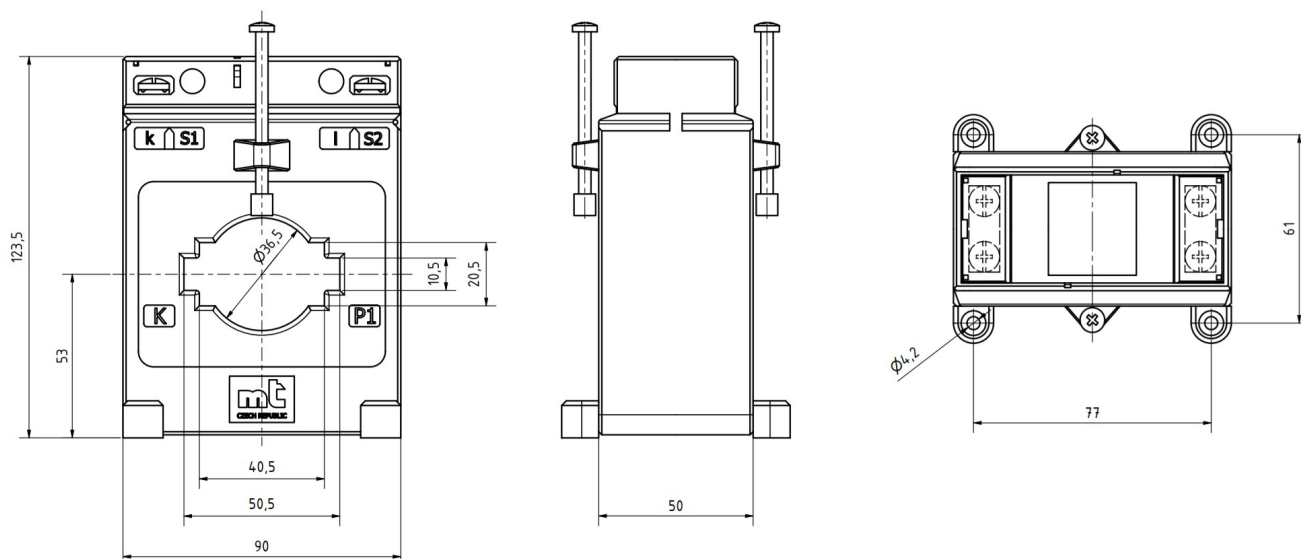

Low-voltage instrument current transformer

CLB 6.91

Primary bar

Round conductor
Transformer width

60x10 mm
50x30 mm
 ϕ 44 mm
90 mm

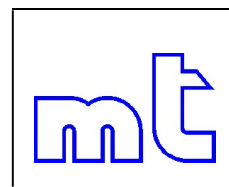

insulation voltage 0,72 kV, test voltage 3 kV, frequency 50 - 60 Hz,
 $I_{therm} = 60 \times I_{1n}$, $I_{dyn} = 150 \times I_{1n}$

Primary current range 125 – 1000 A



A completely enclosed mini current transformer, most appropriate for use in low-voltage switchboard plants for indoor installation. It can be used for the connection of ammeters and current circuits of meters, protective and other measuring devices.

Core and secondary winding are housed in a black case of self-extinguishing material. Insulation class E, max. constant temperature 120°C.

The secondary terminals are sealable.

The transformer can be mounted in all position on busbars of square or round cross-section. It can also be mounted on the specially made frames by means of four screws in such a way that the primary conductor freely passes through the transformer hole.

The transformers are made according to the standards ČSN 35 1360, ČSN 35 1301, ČSN EN 60044-1, ČSN EN 61869-2 (Czech Standards) and of course IEC 60044-1 and IEC 61869-2. Each transformer is thoroughly tested in the factory. The factory test certificate is provided upon request.

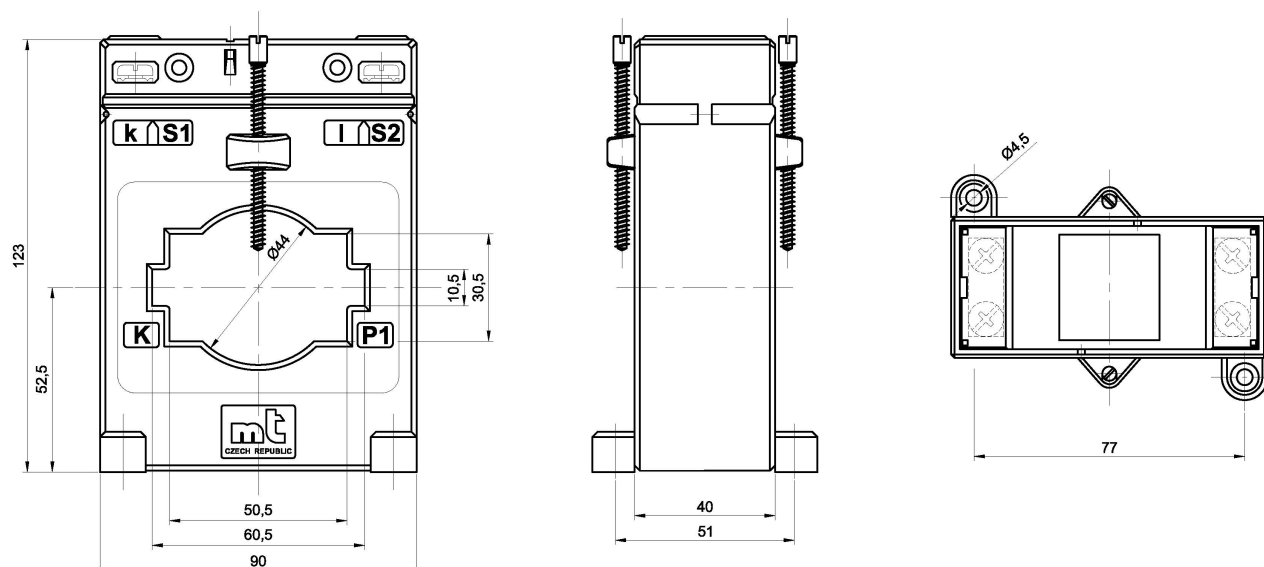

Low-voltage instrument current transformer

CLB 6.92

Primary bar

Round conductor
Transformer width

60x10 mm
50x30 mm
 ϕ 44 mm
90 mm

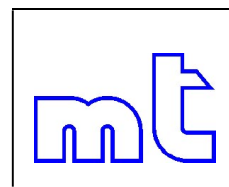

insulation voltage 0,72 kV, test voltage 3 kV, frequency 50 - 60 Hz,
 $I_{therm} = 60 \times I_{1n}$, $I_{dyn} = 150 \times I_{1n}$

Primary current range 75 – 1000 A



A completely enclosed mini current transformer, most appropriate for use in low-voltage switchboard plants for indoor installation. It can be used for the connection of ammeters and current circuits of meters, protective and other measuring devices.

Core and secondary winding are housed in a black case of self-extinguishing material. Insulation class E, max. constant temperature 120°C.

The secondary terminals are sealable.

The transformer can be mounted in all position on busbars of square or round cross-section. It can also be mounted on the specially made frames by means of four screws in such a way that the primary conductor freely passes through the transformer hole.

The transformers are made according to the standards ČSN 35 1360, ČSN 35 1301, ČSN EN 60044-1, ČSN EN 61869-2 (Czech Standards) and of course IEC 60044-1 and IEC 61869-2. Each transformer is thoroughly tested in the factory. The factory test certificate is provided upon request.

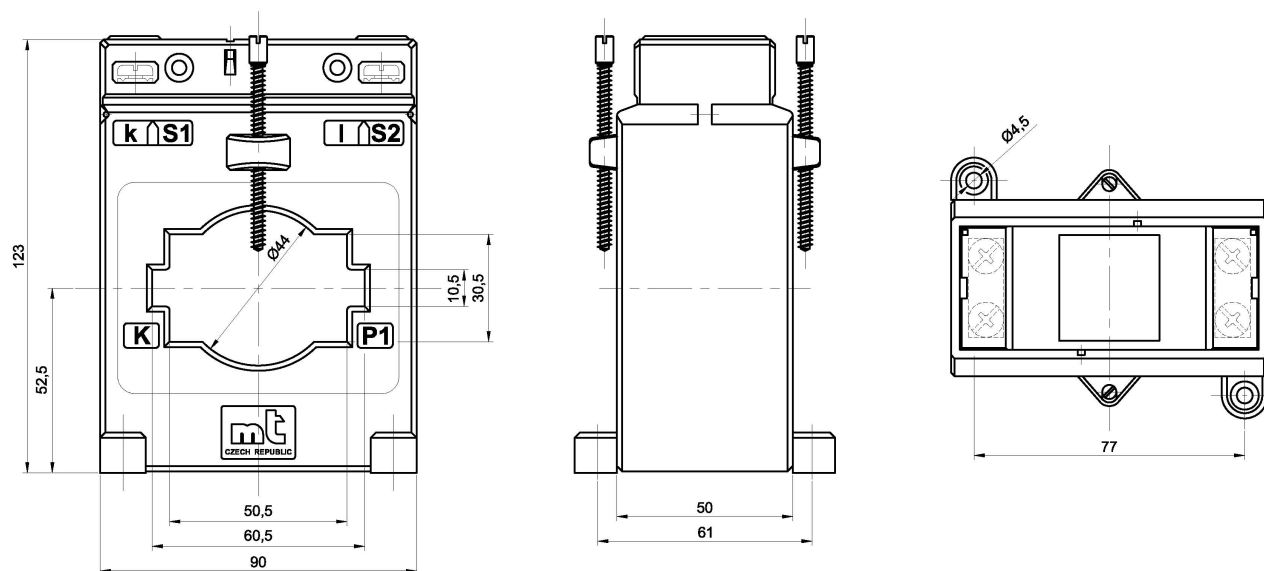

Low-voltage instrument current transformer

CLB 10

Primary bar

Round conductor
Transformer width

100x10 mm
80x30 mm
 ϕ 70 mm
131 mm

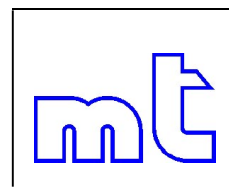

insulation voltage 0,72 kV, test voltage 3 kV, frequency 50 - 60 Hz,
 $I_{therm} = 60 \times I_{1n}$, $I_{dyn} = 150 \times I_{1n}$

Primary current range 400 – 3000 A



A completely enclosed mini current transformer, most appropriate for use in low-voltage switchboard plants for indoor installation. It can be used for the connection of ammeters and current circuits of meters, protective and other measuring devices.

Core and secondary winding are housed in a black case of self-extinguishing material. Insulation class E, max. constant temperature 120°C.

The secondary terminals are sealable.

The transformer can be mounted in all position on busbars of square or round cross-section. It can also be mounted on the specially made frames by means of four screws in such a way that the primary conductor freely passes through the transformer hole.

The transformers are made according to the standards ČSN 35 1360, ČSN 35 1301, ČSN EN 60044-1, ČSN EN 61869-2 (Czech Standards) and of course IEC 60044-1 and IEC 61869-2. Each transformer is thoroughly tested in the factory. The factory test certificate is provided upon request.

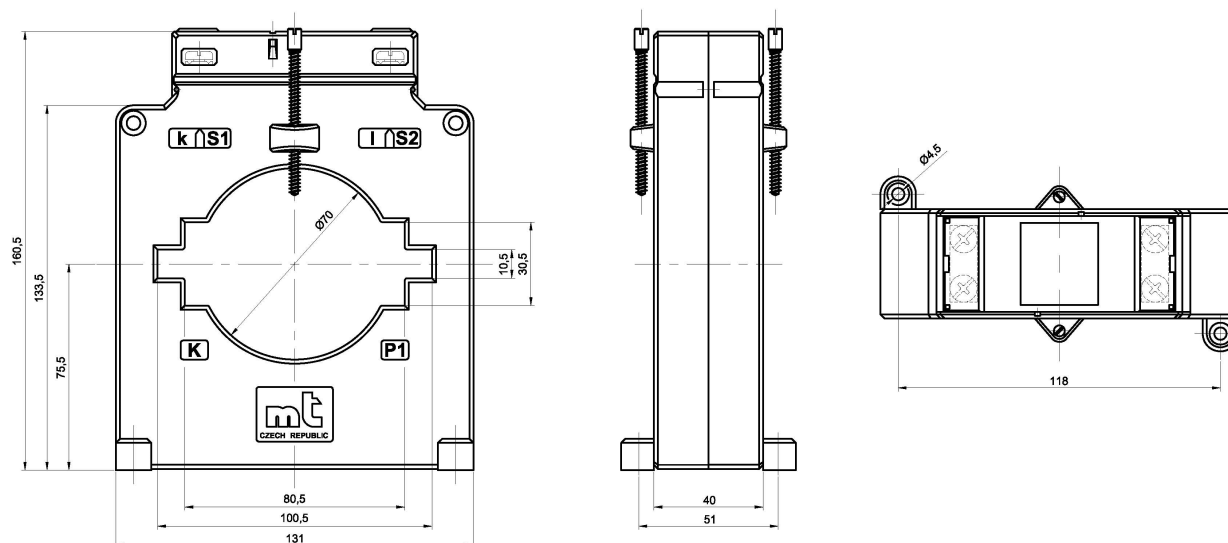

Low-voltage instrument current transformer

CLB 2.64

Primary bar

Round conductor
Transformer width

20x10 mm
20x10 mm
 ϕ 20 mm
60 mm

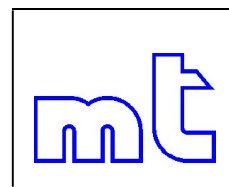

insulation voltage 0,72 kV, test voltage 3 kV, frequency 50 - 60 Hz,
 $I_{therm} = 60 \times I_{1n}$, $I_{dyn} = 150 \times I_{1n}$

Primary current range 50 – 400 A



A completely enclosed mini current transformer, most appropriate for use in low-voltage switchboard plants for indoor installation. It can be used for the connection of ammeters and current circuits of meters, protective and other measuring devices.

Core and secondary winding are housed in a black case of self-extinguishing material. Insulation class E, max. constant temperature 120°C.

The secondary terminals are sealable.

The transformer can be mounted in all position on busbars of square or round cross-section. It can also be mounted on the specially made frames by means of four screws in such a way that the primary conductor freely passes through the transformer hole.

The transformers are made according to the standards ČSN 35 1360, ČSN 35 1301, ČSN EN 60044-1, ČSN EN 61869-2 (Czech Standards) and of course IEC 60044-1 and IEC 61869-2. Each transformer is thoroughly tested in the factory. The factory test certificate is provided upon request.

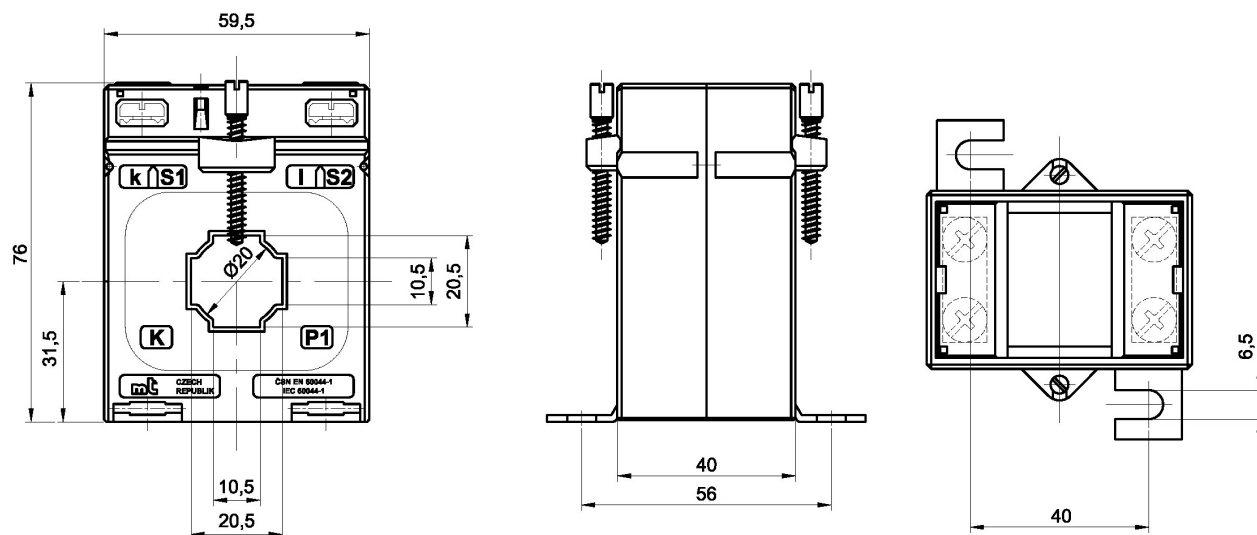

Low-voltage instrument current transformer

CLB 2.65

Primary bar

Round conductor
Transformer width

20x10 mm
20x10 mm
 ϕ 20 mm
60 mm

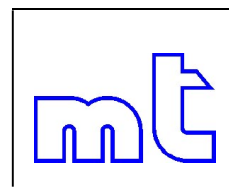

insulation voltage 0,72 kV, test voltage 3 kV, frequency 50 - 60 Hz,
 $I_{therm} = 60 \times I_{1n}$, $I_{dyn} = 150 \times I_{1n}$

Primary current range 50 – 500 A



A completely enclosed mini current transformer, most appropriate for use in low-voltage switchboard plants for indoor installation. It can be used for the connection of ammeters and current circuits of meters, protective and other measuring devices.

Core and secondary winding are housed in a black case of self-extinguishing material. Insulation class E, max. constant temperature 120°C.

The secondary terminals are sealable.

The transformer can be mounted in all position on busbars of square or round cross-section. It can also be mounted on the specially made frames by means of four screws in such a way that the primary conductor freely passes through the transformer hole.

The transformers are made according to the standards ČSN 35 1360, ČSN 35 1301, ČSN EN 60044-1, ČSN EN 61869-2 (Czech Standards) and of course IEC 60044-1 and IEC 61869-2. Each transformer is thoroughly tested in the factory. The factory test certificate is provided upon request.

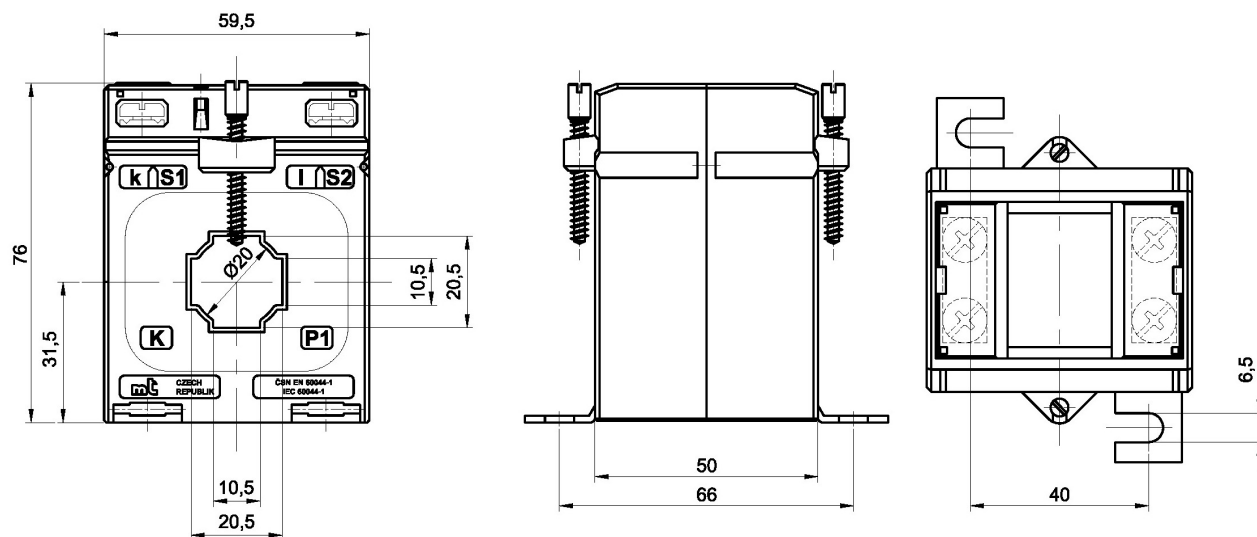

Low-voltage instrument current transformer

CLB 3.65

Primary bar

Round conductor
Transformer width

30x10 mm
30x10 mm
 ϕ 28 mm
60 mm

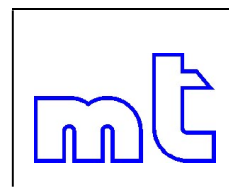

insulation voltage 0,72 kV, test voltage 3 kV, frequency 50 - 60 Hz,
 $I_{therm} = 60 \times I_{1n}$, $I_{dyn} = 150 \times I_{1n}$

Primary current range 50 – 500 A



A completely enclosed mini current transformer, most appropriate for use in low-voltage switchboard plants for indoor installation. It can be used for the connection of ammeters and current circuits of meters, protective and other measuring devices.

Core and secondary winding are housed in a black case of self-extinguishing material. Insulation class E, max. constant temperature 120°C.

The secondary terminals are sealable.

The transformer can be mounted in all position on busbars of square or round cross-section. It can also be mounted on the specially made frames by means of four screws in such a way that the primary conductor freely passes through the transformer hole.

The transformers are made according to the standards ČSN 35 1360, ČSN 35 1301, ČSN EN 60044-1, ČSN EN 61869-2 (Czech Standards) and of course IEC 60044-1 and IEC 61869-2. Each transformer is thoroughly tested in the factory. The factory test certificate is provided upon request.

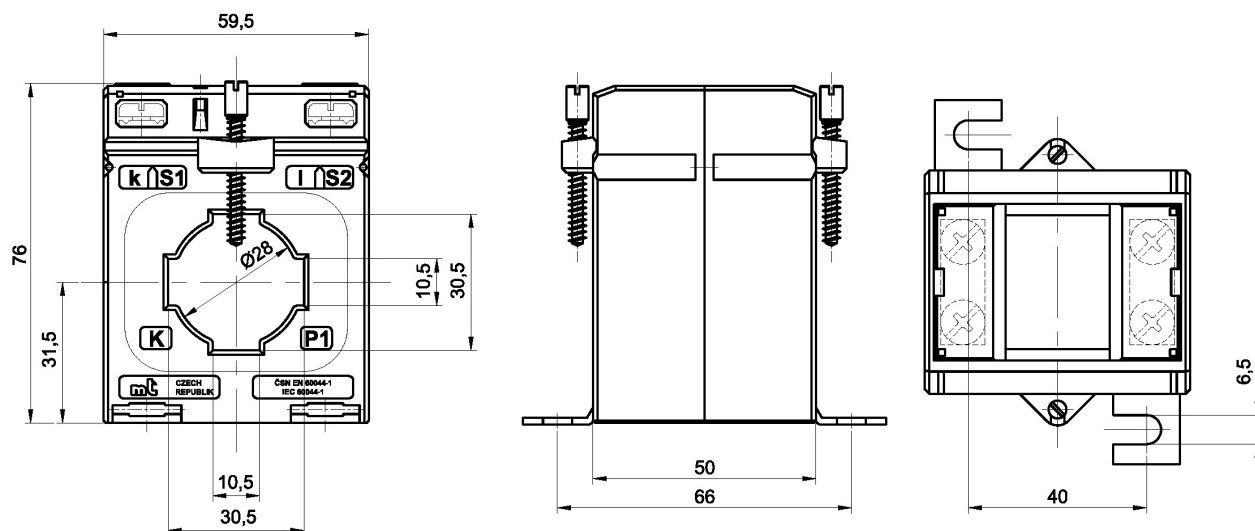

Low-voltage instrument current transformer

CLB 32.64

Primary bar

Round conductor
Transformer width

32x10 mm
30x15 mm
25x20 mm
φ 30 mm
60 mm

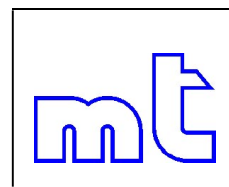

insulation voltage 0,72 kV, test voltage 3 kV, frequency 50 - 60 Hz,
 $I_{therm} = 60 \times I_{1n}$, $I_{dyn} = 150 \times I_{1n}$

Primary current range 50 – 750 A



A completely enclosed mini current transformer, most appropriate for use in low-voltage switchboard plants for indoor installation. It can be used for the connection of ammeters and current circuits of meters, protective and other measuring devices.

Core and secondary winding are housed in a black case of self-extinguishing material. Insulation class E, max. constant temperature 120°C.

The secondary terminals are sealable.

The transformer can be mounted in all position on busbars of square or round cross-section. It can also be mounted on the specially made frames by means of four screws in such a way that the primary conductor freely passes through the transformer hole.

The transformers are made according to the standards ČSN 35 1360, ČSN 35 1301, ČSN EN 60044-1, ČSN EN 61869-2 (Czech Standards) and of course IEC 60044-1 and IEC 61869-2. Each transformer is thoroughly tested in the factory. The factory test certificate is provided upon request.

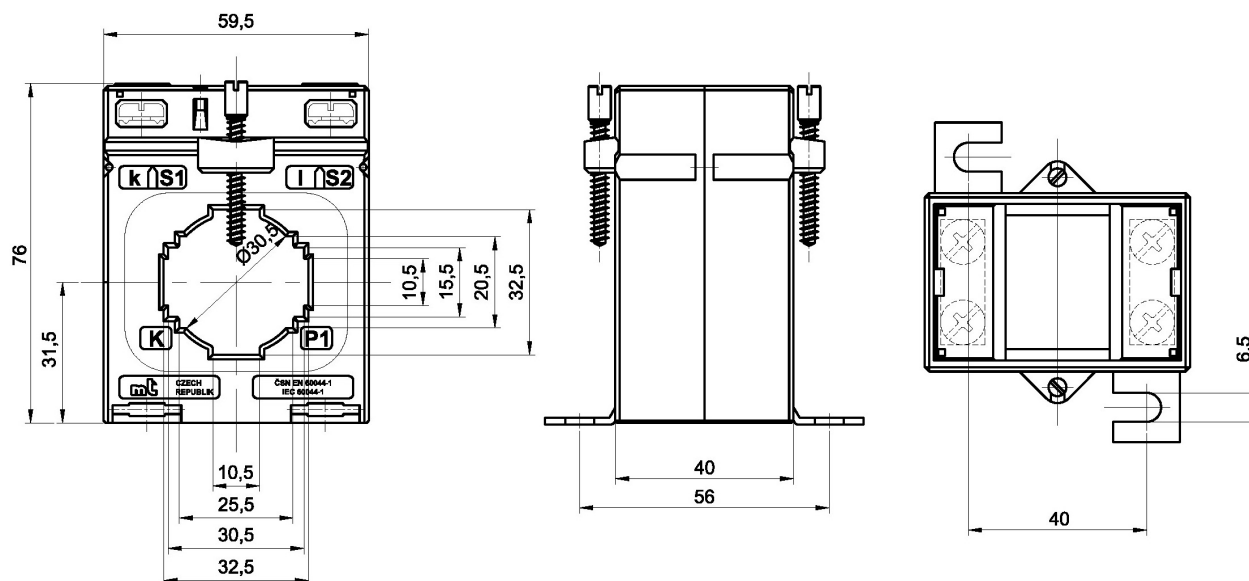

Low-voltage instrument current transformer

CLB 32.65

Primary bar

Round conductor
Transformer width

32x10 mm
30x15 mm
25x20 mm
φ 30 mm
60 mm

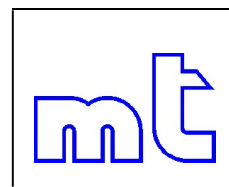

insulation voltage 0,72 kV, test voltage 3 kV, frequency 50 - 60 Hz,
 $I_{therm} = 60 \times I_{1n}$, $I_{dyn} = 150 \times I_{1n}$

Primary current range 50 – 750 A



A completely enclosed mini current transformer, most appropriate for use in low-voltage switchboard plants for indoor installation. It can be used for the connection of ammeters and current circuits of meters, protective and other measuring devices.

Core and secondary winding are housed in a black case of self-extinguishing material. Insulation class E, max. constant temperature 120°C.

The secondary terminals are sealable.

The transformer can be mounted in all position on busbars of square or round cross-section. It can also be mounted on the specially made frames by means of four screws in such a way that the primary conductor freely passes through the transformer hole.

The transformers are made according to the standards ČSN 35 1360, ČSN 35 1301, ČSN EN 60044-1, ČSN EN 61869-2 (Czech Standards) and of course IEC 60044-1 and IEC 61869-2. Each transformer is thoroughly tested in the factory. The factory test certificate is provided upon request.

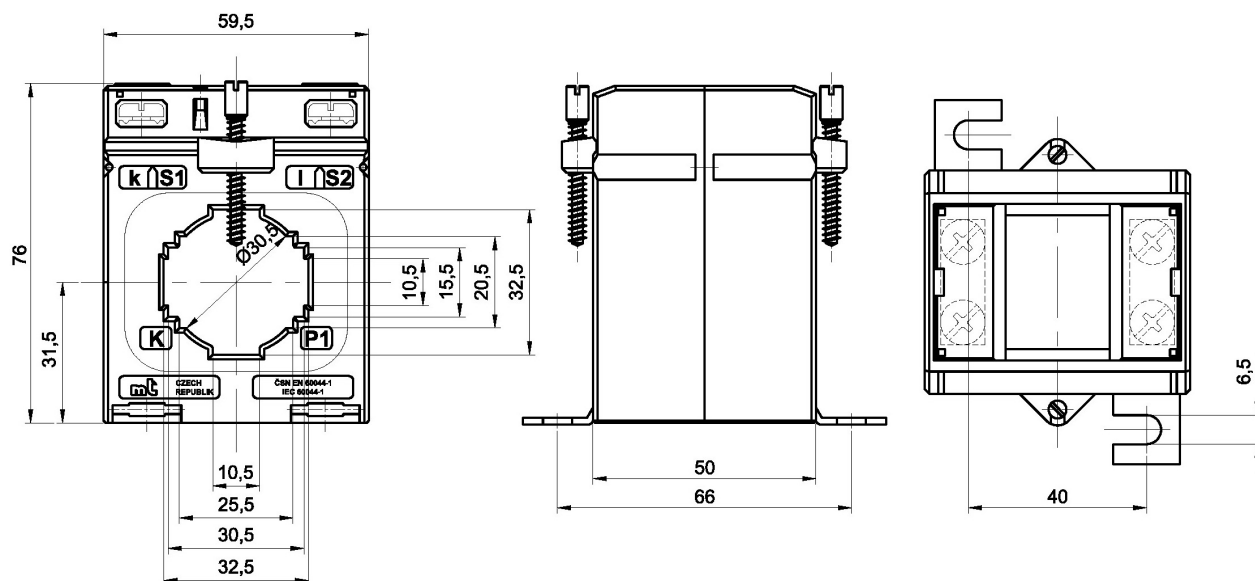

Low-voltage instrument current transformer

CLB 22R.63

Round conductor
Transformer width

φ 22 mm
60 mm

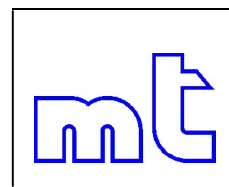

insulation voltage 0,72 kV, test voltage 3 kV, frequency 50 - 60 Hz,
 $I_{therm} = 60 \times I_{1n}$, $I_{dyn} = 150 \times I_{1n}$

Primary current range 50 – 600 A



A completely enclosed mini current transformer, most appropriate for use in low-voltage switchboard plants for indoor installation. It can be used for the connection of ammeters and current circuits of meters, protective and other measuring devices.

Core and secondary winding are housed in a black case of self-extinguishing material. Insulation class E, max. constant temperature 120°C.

The secondary terminals are sealable.

The transformer can be mounted in all position on busbars of square or round cross-section. It can also be mounted on the specially made frames by means of four screws in such a way that the primary conductor freely passes through the transformer hole.

The transformers are made according to the standards ČSN 35 1360, ČSN 35 1301, ČSN EN 60044-1, ČSN EN 61869-2 (Czech Standards) and of course IEC 60044-1 and IEC 61869-2. Each transformer is thoroughly tested in the factory. The factory test certificate is provided upon request.

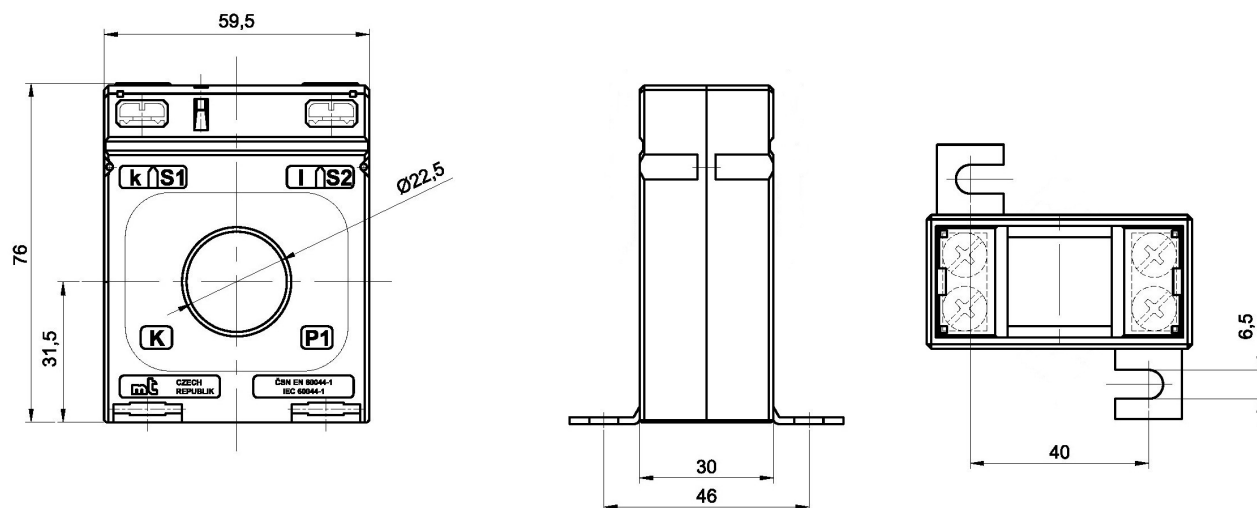

Low-voltage instrument current transformer

CLB 22R.64

Round conductor
Transformer width

φ 22 mm
60 mm

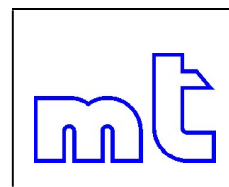

insulation voltage 0,72 kV, test voltage 3 kV, frequency 50 - 60 Hz,
 $I_{therm} = 60 \times I_{1n}$, $I_{dyn} = 150 \times I_{1n}$

Primary current range 50 – 600 A



A completely enclosed mini current transformer, most appropriate for use in low-voltage switchboard plants for indoor installation. It can be used for the connection of ammeters and current circuits of meters, protective and other measuring devices.

Core and secondary winding are housed in a black case of self-extinguishing material. Insulation class E, max. constant temperature 120°C.

The secondary terminals are sealable.

The transformer can be mounted in all position on busbars of square or round cross-section. It can also be mounted on the specially made frames by means of four screws in such a way that the primary conductor freely passes through the transformer hole.

The transformers are made according to the standards ČSN 35 1360, ČSN 35 1301, ČSN EN 60044-1, ČSN EN 61869-2 (Czech Standards) and of course IEC 60044-1 and IEC 61869-2. Each transformer is thoroughly tested in the factory. The factory test certificate is provided upon request.

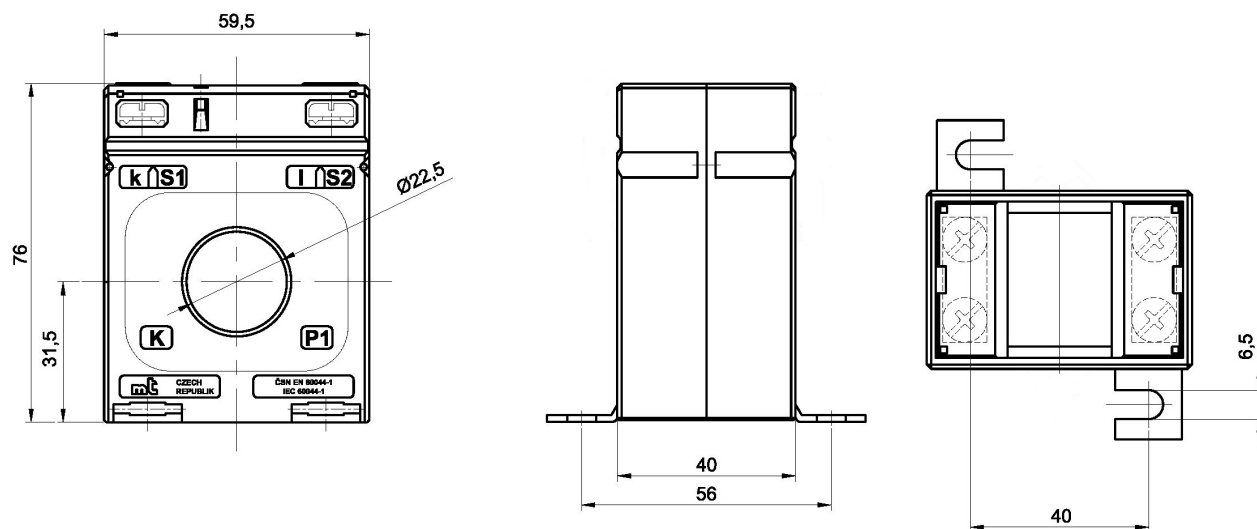

Low-voltage instrument current transformer

CLB 4.63

Primary bar

Round conductor
Transformer width

40x12,5 mm
32x15 mm
 ϕ 26 mm
60 mm

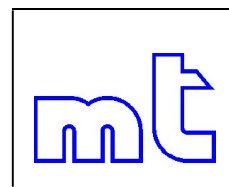

insulation voltage 0,72 kV, test voltage 3 kV, frequency 50 - 60 Hz,
 $I_{therm} = 60 \times I_{1n}$, $I_{dyn} = 150 \times I_{1n}$

Primary current range 100 – 800 A



A completely enclosed mini current transformer, most appropriate for use in low-voltage switchboard plants for indoor installation. It can be used for the connection of ammeters and current circuits of meters, protective and other measuring devices.

Core and secondary winding are housed in a black case of self-extinguishing material. Insulation class E, max. constant temperature 120°C.

The secondary terminals are sealable.

The transformer can be mounted in all position on busbars of square or round cross-section. It can also be mounted on the specially made frames by means of four screws in such a way that the primary conductor freely passes through the transformer hole.

The transformers are made according to the standards ČSN 35 1360, ČSN 35 1301, ČSN EN 60044-1, ČSN EN 61869-2 (Czech Standards) and of course IEC 60044-1 and IEC 61869-2. Each transformer is thoroughly tested in the factory. The factory test certificate is provided upon request.

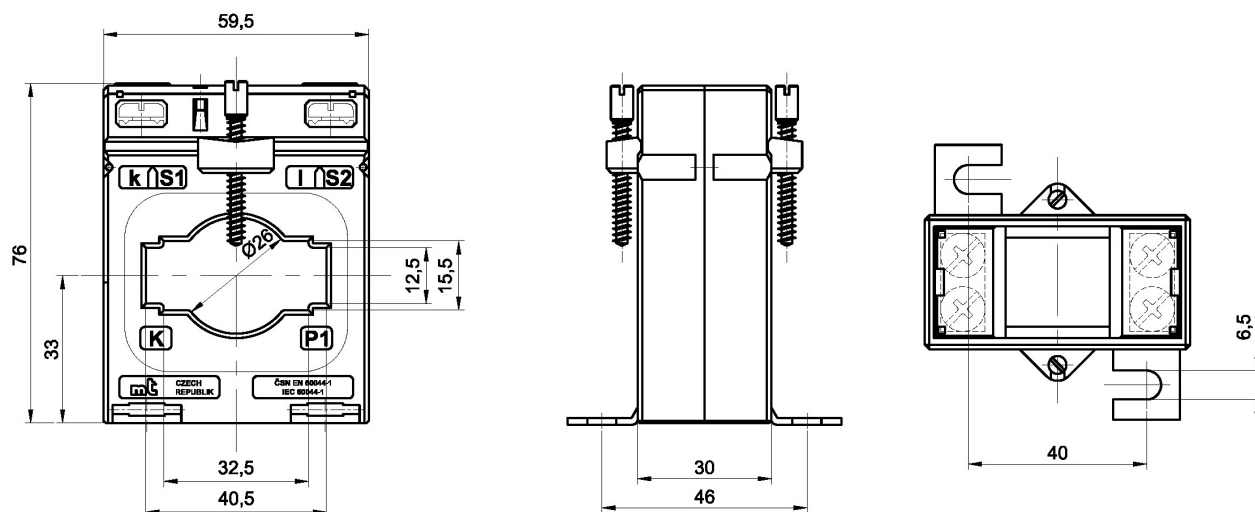

Low-voltage instrument current transformer

CLB 4.64

Primary bar

40x12,5 mm

Round conductor

32x15 mm

Transformer width

φ 26 mm

60 mm

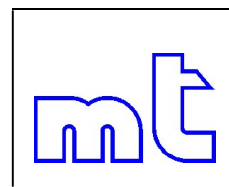

insulation voltage 0,72 kV, test voltage 3 kV, frequency 50 - 60 Hz,
 $I_{therm} = 60 \times I_{1n}$, $I_{dyn} = 150 \times I_{1n}$

Primary current range 100 – 800 A



A completely enclosed mini current transformer, most appropriate for use in low-voltage switchboard plants for indoor installation. It can be used for the connection of ammeters and current circuits of meters, protective and other measuring devices.

Core and secondary winding are housed in a black case of self-extinguishing material. Insulation class E, max. constant temperature 120°C.

The secondary terminals are sealable.

The transformer can be mounted in all position on busbars of square or round cross-section. It can also be mounted on the specially made frames by means of four screws in such a way that the primary conductor freely passes through the transformer hole.

The transformers are made according to the standards ČSN 35 1360, ČSN 35 1301, ČSN EN 60044-1, ČSN EN 61869-2 (Czech Standards) and of course IEC 60044-1 and IEC 61869-2. Each transformer is thoroughly tested in the factory. The factory test certificate is provided upon request.

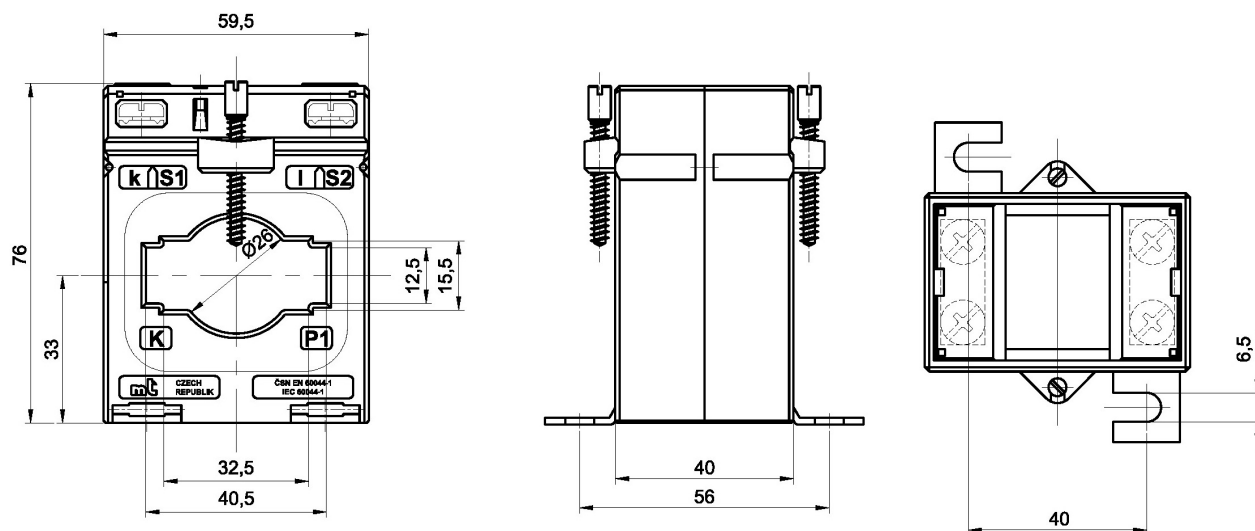

Low-voltage instrument current transformer

CLB 0.65

Wire with terminal
Round conductor

25 – 200 mm

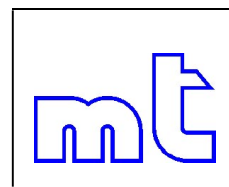

insulation voltage 0,72 kV, test voltage 3 kV, frequency 50 - 60 Hz,
 $I_{therm} = 60 \times I_{1n}$, $I_{dyn} = 150 \times I_{1n}$

Primary current range 1 – 10 A



A completely enclosed mini current transformer, most appropriate for use in low-voltage switchboard plants for indoor installation. It can be used for the connection of ammeters and current circuits of meters, protective and other measuring devices.

Core and secondary winding are housed in a black case of self-extinguishing material. Insulation class E, max. constant temperature 120°C.

The secondary terminals are sealable.

The transformer can be mounted in all position on busbars of square or round cross-section. It can also be mounted on the specially made frames by means of four screws in such a way that the primary conductor freely passes through the transformer hole.

The transformers are made according to the standards ČSN 35 1360, ČSN 35 1301, ČSN EN 60044-1, ČSN EN 61869-2 (Czech Standards) and of course IEC 60044-1 and IEC 61869-2. Each transformer is thoroughly tested in the factory. The factory test certificate is provided upon request.

